

SC 500



The automatic SC 500 continuous side seal machine has been designed to pack a great range of products whatever might be the length, with shrink and non shrink films, achieving productions up to 125 cycles/min.

With simple regulations, quickly adapts to the different products to be wrapped, without need of tools. Side sealed packs avoid seals over the top and bottom of the package, allowing a clear view of the product.

An industrial PC control system includes a simple and quick communication via touch screen, providing constant complete diagnostics of the machine status and the control parameters.

BASIC EQUIPMENT

- High quality packaging without seal tensions and intermediate belt.
- Automatic in-line conveyor belt feeding system with product separation and alignment and manual conveyor width regulation.
- Motorized 90° reel holder with adjustable mechanical perforation and end-of-film detection.
- In feed moving belt to make the change and load of film easier.
- Motorized triangle frame height.
- Intermittent working mode: pack after pack.
- Side seal with heated rollers with temperature regulation.
- Cross seal and cut by hot knife with temperature regulations and opening at any height.

- Automatic adjustment of the sealing height .
- Automatic film scrap wheel with easy access. Film distribution device and film break detection.
- "No product - No bag" device.
- 5" touch screen industrial PC control, for up to 100 different product format memory and operation diagnosis.
- Protections and safety systems according to CE regulations.

OPTIONAL DEVICES

- Automatic pack format adjustment.
- Cross sealing bar and side seal for PE.
- Film folding system from flat to centrefold. Perforación neumática y/o en caliente del film.
- Pneumatic hole punch and/or hot film perforation.
- Intermediate aspiration belt for light product transfer.
- Easy opening package device. Device for unstable products.
- Double reel holder.
- End-of-film light and sound alarm.
- Film centring device for printed film.
- Machine direction: from left to right.
- Stainless steel version.
- Different feeding and exit elements (feeders, printers, labellers, conveyors...)
- MODEM for failure diagnostic.

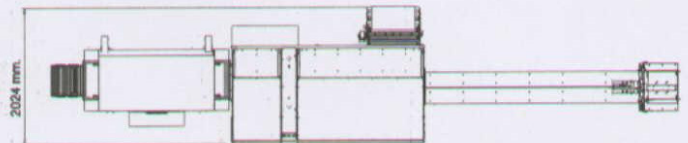
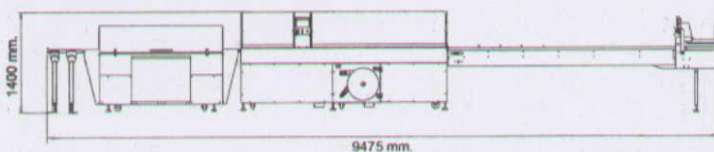

TECHNICAL FEATURES

SC 505

Transversal jaw dimensions		550 mm
Product dimensions (All the maximum product dimensions not compatible. Other product dimensions under consult)	Length	80 – ∞ MM
	Width	55 – 480 MM
	Height	1 – 200 MM
Maximum production (Depending on product and film)		8.000 cycles/h.
Type of film		STD: Polyolefin (PO) and PVC / OPC: Polyethylene (PE)
Max. Reel dimensions		∅ 350 x 600 mm.
Type of reel		STD: Centrefold / OPC: Flat
Electrical specifications	Voltage	400 V. Three phase + Neutral + Ground 50 / 60 Hz.
	Consumption aprox.	4,2 KW. – 10 A
Pneumatic consumption		14 l/min. - 6 bar
Machine dimensions (L x W x H)		2900 x 1.400 x 2.060 MM
Weight		1.050 Kg.

ULMA reserves the right to modify the features without prior notice.



Idépack Verpakkingsmachines BV
 Zeilmaker 8
 NL-3861 SM Nijkerk
 THE NETHERLANDS
 Tel.: +31(0)33 - 299 00 08
 Web: www.idepack.com
 e-mail: info@idepack.com